

Miniature Angular Contact Bearings

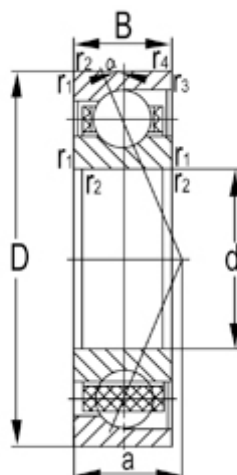

select	Inquiry Bearing Number		Dimensions			Basic Load Rating		Limiting Speed	
			d	D	B	Cr(N)	Cor(N)	Grease	Oil
B.706.C	6	17	6	2.39	0.99	90000	155000		
B.706.AC	6	17	6	2.3	0.95	80000	135000		
HC.B.706.C	6	17	6	1.65	0.69	115000	180000		
HC.B.706.AC	6	17	6	1.58	0.69	95000	165000		
HS.706.C	6	17	6	1.59	0.9	110000	185000		
HS.706.AC	6	17	6	1.52	0.69	95000	160000		
HC.706.C	6	17	6	1.1	0.5	130000	210000		
HC.706.AC	6	17	6	1.06	0.48	115000	185000		
B.707.C	7	19	6	2.8	1.18	80000	135000		
B.707.AC	7	19	6	2.7	1.4	70000	115000		
HC.B.707.C	7	19	6	1.9	0.9	105000	175000		
HC.B.707.AC	7	19	6	1.75	0.79	90000	150000		
HS.707.C	7	19	6	1.9	0.9	105000	170000		
HS.707.AC	7	19	6	1.7	0.79	85000	145000		
HC.707.C	7	19	6	1.18	0.59	115000	180000		
HC.707.AC	7	19	6	1.14	0.56	105000	175000		
B.708.C	8	22	7	3.9	1.75	70000	115000		
B.708.AC	8	22	7	3.78	1.69	62000	95000		

Miniature Angular Contact Bearings

HC.B.708.C	8	22	7	2.67	1.22	90000	155000
HC.B.708.AC	8	22	7	2.58	1.18	75000	125000
HS.708.C	8	22	7	1.95	1.1	90000	155000
HS.708.AC	8	22	7	1.82	0.97	75000	125000
HC.708.C	8	22	7	1.3	0.72	105000	175000
HC.708.AC	8	22	7	1.25	0.68	85000	145000
B.709.C	9	24	7	5.3	2.5	62000	95000
B.709.AC	9	24	7	5.14	2.33	55000	85000
HC.B.709.C	9	24	7	3.64	1.69	80000	130000
HC.B.709.AC	9	24	7	3.48	1.63	70000	115000
HS.709.C	9	24	7	2.68	1.47	80000	135000
HS.709.AC	9	24	7	2.52	1.39	70000	115000